

## INTERIOR BALLUSTRADING COMPONENT SPECIFICATIONS

Our **INTERIOR** range is clear TBTO treated to SABS specifications.

Component	Code	Size (mm)	Quantity
<b>INTERIOR NEWEL POSTS - COLONIAL &amp; SQUARE STYLES</b>			
82 mm <b>Colonial</b> Newel Posts (ball caps are part of the post)			
Colonial Intermediate Newel for 90° turn with landing	INC01	82 x 82 x 1800	
Colonial Intermediate Newel for 90° turn with winder	INC02	82 x 82 x 1800	
Colonial Newel for bottom & top of stairs	INC03	82 x 82 x 1580	
Colonial Newel for bottom & top of stairs	INC04	82 x 82 x 1320	
Colonial Half Newel (against wall)	INC05	41 x 82 x 1320	
82mm <b>Square</b> Newel Posts (caps come in two styles and are <i>not</i> part of the post)			
Square Newel Post	INS01	82 x 82 x 1800	
Square Newel Post	INS02	82 x 82 x 1580	
Square Newel Post	INS03	82 x 82 x 1320	
Half Square Newel Post (against wall)	INS04	41 x 82 x 1320	
<b>INTERIOR BALLS AND CAPS FOR 82 mm SQUARE POSTS</b>			
Ball	IB1	75 x 95	
Half Ball (against wall)	IB2	37 x 95	
Cap	IC01	111 x 111 x 30	
Half Cap (against wall)	IC02	55 x 111 x 30	
<b>INTERIOR UNDER-RAIL INTERMEDIATE NEWEL POSTS</b>			
Colonial intermediate	IIC02	65 x 65 x 1160	
Square intermediate	IIS01	65 x 65 x 1160	
<b>INTERIOR HAND RAIL - WITH FILLET</b>			
2400 Hand Rail with Fillet	IH01	65 x 42 x 2400	
3600 Hand Rail with Fillet	IH02	65 x 42 x 3600	
<b>INTERIOR BASE RAIL - WITH FILLET</b>			
2400 Base Rail with Fillet	IB01	65 x 32 x 2400	
3600 Base Rail with Fillet	IB02	65 x 32 x 3600	
<b>INTERIOR BALUSTERS - COLONIAL &amp; SQUARE STYLES</b>			
Colonial Stopdle	IBC02	42 x 42 x 900	
Square Baluster	IBS01	42 x 42 x 900	
<b>INTERIOR ACCESSORIES - all fasteners included</b>			
"L" Bracket for Landing	BL01		2
"L" Bracket for Stairs	BL02		2
Newel Side Fixing Kit	IA02		1
Newel Top Fixing Pins	IPO1		1

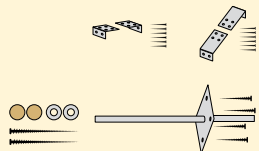
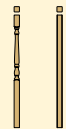
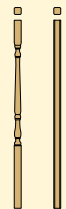
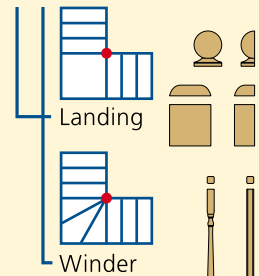
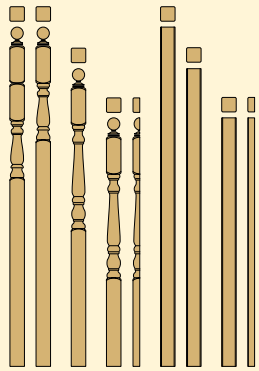

# TWA Banisters

YOUR ULTIMATE BALLUSTRADING SYSTEM

For Balconies & Staircases

## INTERIOR BALLUSTRADING installation instructions



Tel: 0860 105 507 • email: info@twaban.co.za

[www.twaban.co.za](http://www.twaban.co.za)



DEALER:

## THREE SIMPLE STEPS FOR INSTALLING YOUR INTERIOR BANNISTERS

### INTERIOR BANNISTER COMPONENTS - SHOWN "EXPLODED" ON RIGHT

- 1** Newel post - Square or Colonial (not shown)
- 2** Intermediate newel post - Square or Colonial (not shown)
- 3a** Newel post top - ball for square posts
- 3b** Newel post top - cap for square posts
- 4** Newel post side fixing kit
- 5** Newel post top fixing kit
- 6** Base rail with fillet
- 7a** "L" brackets - landing
- 7b** "L" brackets - stairs
- 8** Ballusters - Square or Colonial (not shown)
- 9** Hand rail with fillet

**1** Fix Newel posts and Intermediate Newel posts to stringers (side fixing) or stair / landing tops (top fixing).

Fix post tops to Newel posts.

**2** Fix Hand and Base rails to posts with "L" brackets.

Cut Hand and Base rail fillets to lengths to fit between ballusters.

**3** Starting at one end, glue and top one top and one bottom fillet into place. Lever balluster into position. Repeat.

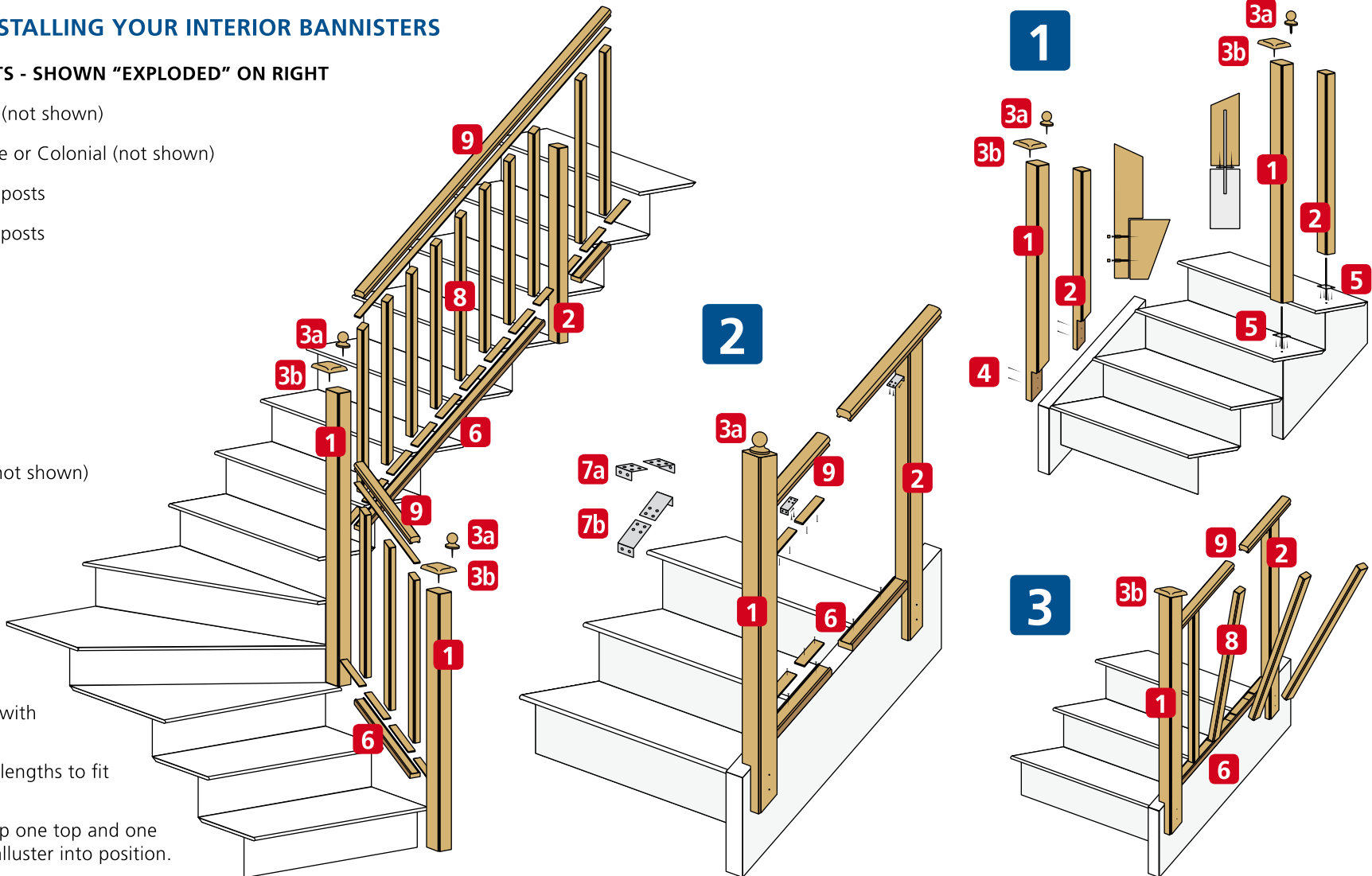

FOR ASSISTANCE OR ADVICE ON ANY ASPECT OF INSTALLATION, CALL OUR TECHNICAL HELPLINE ON 0860 105 507